



### Diamond Ergonomic Interactive Monitor Desk Mount (Model: DMC240)

The Diamond DMC240 dual arm mount is constructed with solid steel and innovative counterbalance technology. Its newly designed VESA plate makes installation much easier. It efficiently frees up space on your desk and easily moves your LCD monitor into the best ergonomic position. Highly adjustable arms move up, down, forward and back with just a touch. With weight capacity of 13.2lbs, the desk mount features 360° monitor rotation, -90°~ +90° tilt, 180°swivel and vertical distance height adjustments. The desk arm is designed with cable management to provide a neat desk space and is ideal for offices, homes, industrial settings, production lines and much more.





## **Product Usage**

- Create a clean sleek look for commercial, business and home/office environments
- Mount two displays to your desk, table or service counter tops and increase your productivity
- Effortlessly swivel, tilt to portrait to landscape rotation views for interactive presenting options

## **Features**

- Counterbalance LCD VESA Desk Mount
  - Effortlessly adjust and position for optimal ergonomic comfort
- Gas spring structure
  - Offers perfect counterbalance presentation in all directions
- Built-in spring tension gauge
  - Can be easily adjusted to fit varied weights the arm holds.
- Grommet Mount
  - Mount your displays through your desk or cabinet.
- Clamp Mount
  - Mount your displays to the side of your desk, table or counter top
- Create a more comfortable environment
  - Improves head and neck postures
- Improve Productivity
  - Employees that are more comfortable are more productive



## Technical Specifications

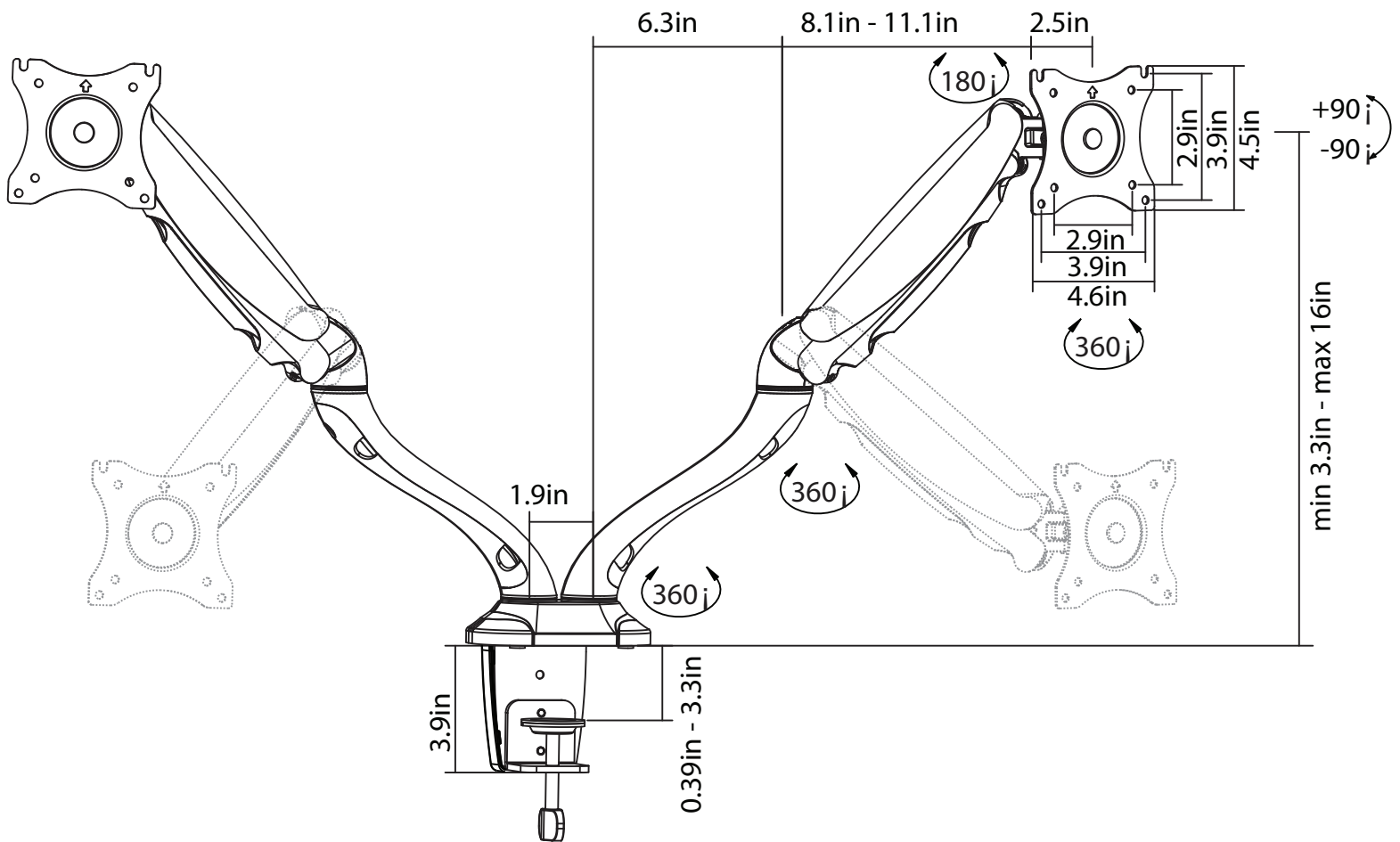



Model	DMC240
UPC	757448024982
Suggested Screen Size	13" – 27"
Rated Load (Per Arm)	13.22 lbs.
VESA Mount Types	75 x 75 100 x 100
Spring Type	Gas
Wall Mountable	No
Tilt	+90° ~ -90°
Rotate	360°
Swivel/Pivot	+180° ~ -180°
Arm Extend	17.4 in.
Mounting Options	Clamp and or Grommet
Color	Black
Material	Steel
Product Weight	9.25 lbs.
Package Weight	12.3 lbs.
Package Dimensions	18.3 x 15.1 x 4.72 in.
Package Contents	
DMC240	
Clamp	
Grommet	
Screws	
Instruction Manual	
Allen Key	